

## ASSEMBLY INSTRUCTIONS

### PETRA LOUNGE 5112

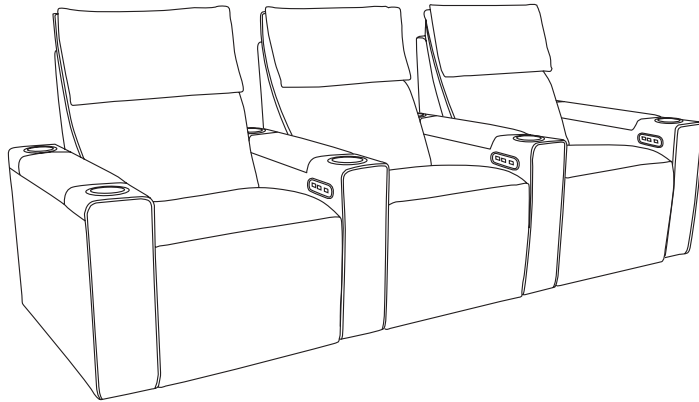

### Petra Immersive Audio Lounge

① The components are heavy, assembly should be performed by two people.

If you have any difficulty with assembly or operation, please contact the store of purchase in the first instance.

Please read the below safety & electrical instructions before operating

#### Safety Instructions

- This product is not intended for use by persons (including children) with reduced physical, sensory or mental capabilities, or lack of experience and knowledge, unless they have been given supervision or instruction concerning use of the product by a person responsible for their safety.
- Ensure there is no person, animal or item obstructing the area under the footrest before operating this product.
- Improper use or installation may result in the risk of fire, electric shock and/or injury. We assume no liability for any eventual damages caused by improper use or inappropriate handling, or by any other non-compliance with the instructions in this manual.
- Children should be supervised to ensure that they do not play with the product.
- This product contains moving parts. Keep fingers, hair and body parts well clear from moving parts. To reduce the risk of injury, keep Children and pets clear of the product when in use.
- Do not sit or place additional weight on the arms, back or open footrest.
- This product is very heavy. Only move this product by lifting the main body. Never drag by the footrest, back or arm rest.
- Return this product to the full upright position to stand safely and prevent a tripping hazard.
- Do not operate this product if damage is visible in any form.
- Do not modify or use unauthorised substitute parts.
- This product has been designed and intended for indoor residential use only. It is not suitable for commercial or outdoor use.
- This product is not intended to be used as part of a health care plan. Consult your medical professional before operating if you are taking medication or have physical limitations.

#### Electrical Instructions

- Never force the back or footrest to close faster than the electric motor.
- Before commencing cleaning or maintenance, ensure this product is disconnected from the power outlet and the back is in the full upright position.
- Disconnect this product from the power outlet before moving.
- Cease operation and disconnect from the power outlet if you ever detect a burning odour or smoke coming from the product.
- Do not operate this product if liquid spillage occurs on or around it. Disconnect from the power outlet and allow product to completely dry before reconnecting.
- Do not operate the power functions or charge station with wet hands.
- Check the condition of the power cord, electrical cords, transformer, plug and connector on a monthly basis. Do not operate if wear is visible on any components.
- Ensure the power cord, electrical cords and transformer are clear of moving parts and not trapped underneath the base.
- Position the power cord to minimise a tripping hazard.
- Never attempt to open or disassemble electrical components.
- We recommend the use of a surge protector (not included).
- Connect power supplies directly to a wall outlet wherever possible. If a powerboard is required, check its maximum power load and don't exceed. Never "daisy-chain" more than one powerboard together.
- Make sure all plugs are connected before plugging the power supply into a power outlet.
- The USB ports (where applicable) are designed with working voltage of 5V, and can not be used to supply power for laptop computers (neither PC or Mac). Plugging a laptop computer into the USB port may end up damaging either the computer or the USB port due to unmatched working voltage.

Synargy is a registered responsible supplier on EESS. Electrical components within our products have been tested to comply with legal requirements imposed for electrical safety and EMC.

#### Step 1

Remove all packaging and set aside in a safe location before disposal or recycling of applicable materials.

On the underside of the backrest there are packages containing the power supplies and feet- remove the packaging and set the items aside. Attach the plastic feet into the pre-drilled holes at the bottom of the sofa.

#### Step 2

Starting with the armchair piece (the set with armrests on both sides of the chair) - take the backrest and place it facing down on the seat base.

Connect the cable between the backrest and seat base - this is for powering the electric headrest.

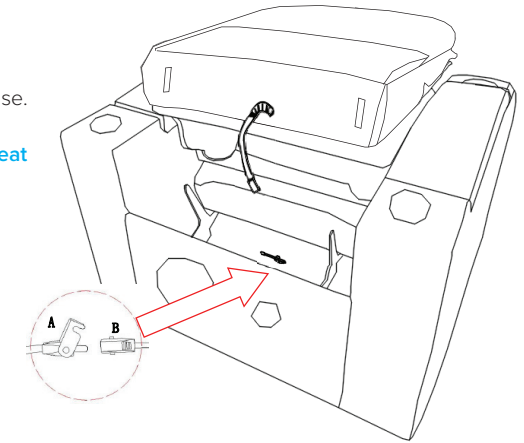

#### Step 3

Lift the backrest to align the metal receivers with the metal posts of the chair base.

Allow the posts to slide into the receivers and press down firmly on the top of the backrest until a click is heard on each side.



Scan QR code for a video of this step

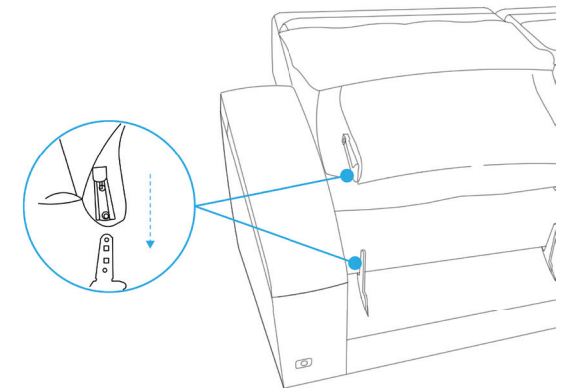

#### Step 4

Plug the power cable (C) into the socket in the back of the lounge suite base.

Connect the other end of the power cable to the transformer (D). Plug the power cord (E) into the other end of the transformer, and plug into a wall outlet to fully power on the lounge suite.

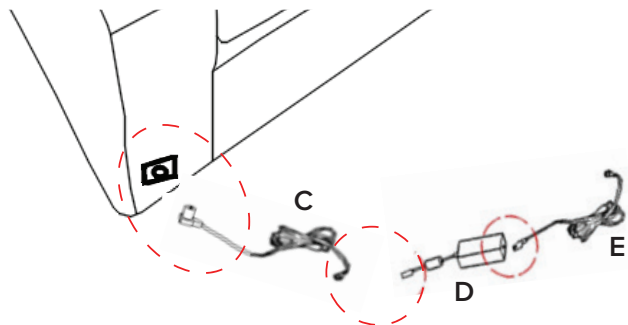

#### Step 5

Repeat these steps for the remaining chairs you have purchased (these ones will just have one armrest.)

Once assembled, arrange them in the desired configuration to make up the finished sofa. There are no physical connections that need to be made between seats.

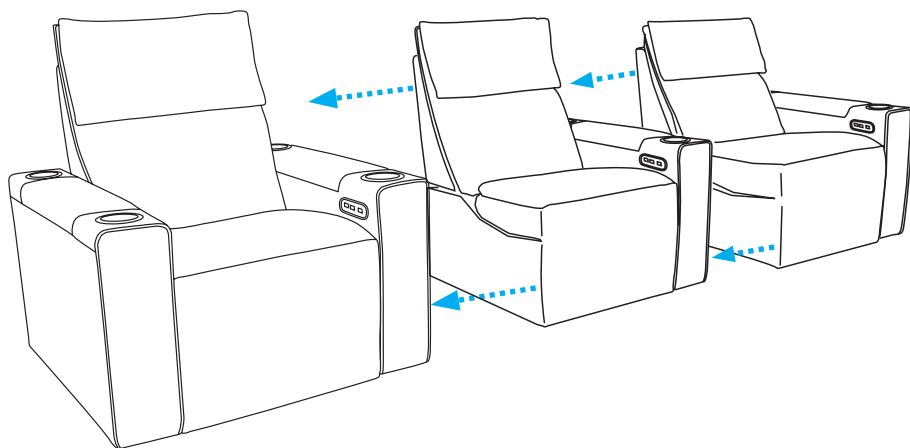

## HAND CONTROLLER OPERATION

**On/off button** used  
to switch the seat  
base & cupholder  
LED lighting on & off  
(automatically turns  
off after 60min)

**Recline buttons**  
used to adjust the  
foot and backrest  
recline angle

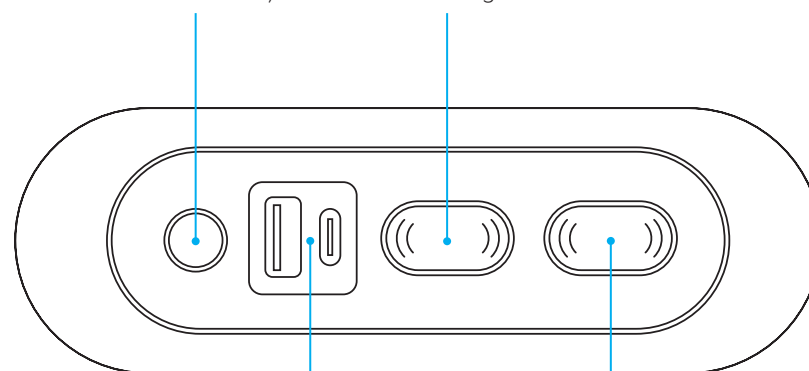

**USB A & C outlets**  
for charging small  
devices such as  
smartphones or  
game controllers

**Headrest buttons**  
used to adjust  
the angle of the  
powered headrest

## THE AUDIO CONTROL PANEL

The **Headphone jack** can be used to listen to audio from your connected source via 3.5mm wired headphones

The **Bluetooth button** is used to turn Bluetooth audio function on, and to setup connection between seats.

Will illuminate Blue when connected to an audio source, and Green when acting as a secondary seat (see next page for detailed instructions).

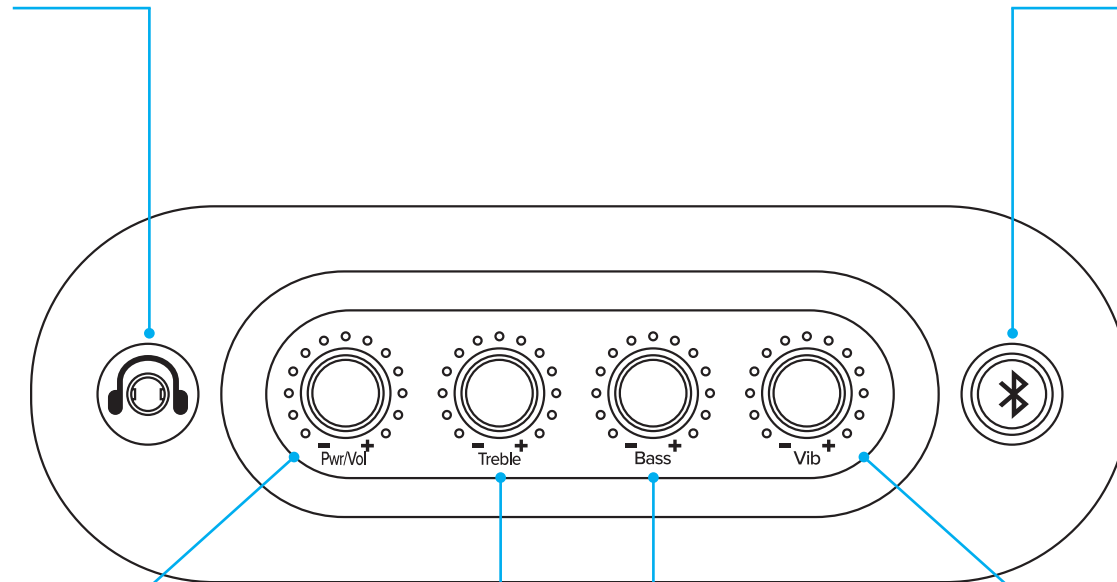

The **Power/Volume dial button** can be held for 3 seconds to turn the sound system on and off. Can be short pressed to pause and play audio, and turned to adjust volume level.

The lights around the Pwr/Vol dial will flash when the Bluetooth is in pairing mode.

The **Treble dial button** can be turned to adjust the treble level, or press for Previous Track from your audio source

The **Bass dial button** can be turned to adjust the bass level, or press for Next Track from your audio source

The **Vibration dial button** can be pressed to turn seat vibration on and off, or turned to adjust the level of intensity. The seat vibration is off by default.

The current level of each of the four dial buttons is indicated by the LED lights illuminated around the perimeter of the dial.

## CONNECTING TO A BLUETOOTH SOURCE

The Bluetooth connections use a Primary and Secondary system. The first seat you connect to from your TV or smartphone will act as the Primary seat. The other seats in your lounge suite connect individually to the Primary seat, and act as Secondary seats. Any of the seats can be set up as the primary seat, it is simply which one you have connected first to the audio source. You can connect up to 4 secondary seats to 1 primary seat. **The Primary seat controls the volume for all other seats. Treble, bass and vibration preferences can all be adjusted on a seat-by-seat basis.**

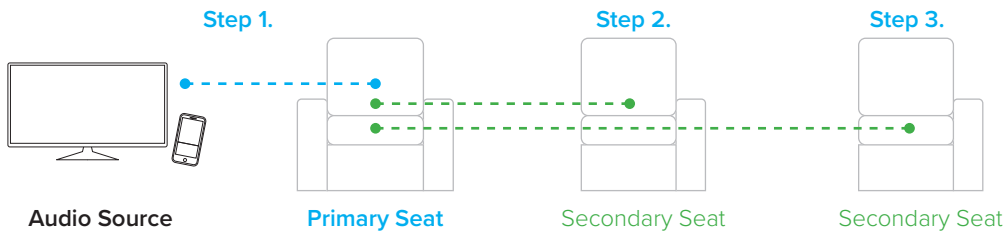

**Step 1:**  
Power on just the primary seat of the lounge suite by pressing the Pwr/Vol dial for 3 seconds. It will automatically enter Bluetooth pairing mode and the LED lights around the Power/Volume dial will be flashing.

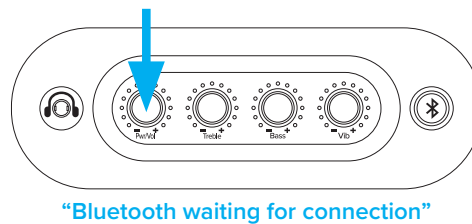

Search for Bluetooth devices on your audio source and connect to the Bluetooth device named **Smart Comfort**.

The backlight on the Bluetooth button will illuminate **blue** when this Primary seat has connected to your audio source.

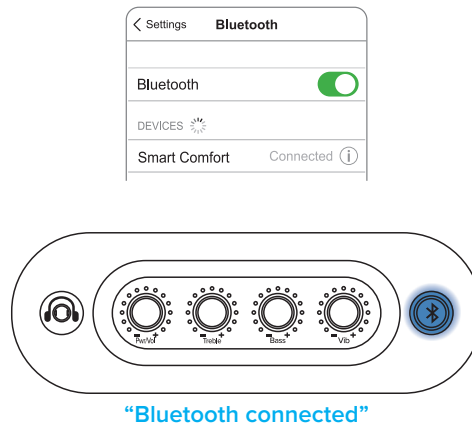

**Step 2:**  
Power on a secondary seat of the lounge suite by pressing the Pwr/Vol dial for 3 seconds.

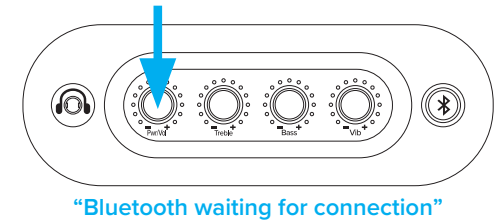

Then press the Bluetooth button on this second seat for 3 seconds.

This Secondary seat will automatically find and connect to the Primary seat.

The backlight on the Bluetooth button will illuminate **green** on this seat when connected.

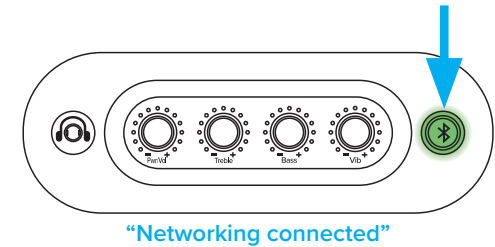

**Step 3:**  
Power on the next Secondary seat, then press the Bluetooth button for 3 seconds for it to also find and connect to the Primary seat.  
Repeat Step 2 for any additional Secondary seats to be connected.  
**A maximum of 4 Secondaries can be connected up to 1 Primary seat. This provides a total of 5 seats running off one audio source.**



Scan QR code for a video  
of the Bluetooth setup instructions

### TROUBLESHOOTING BLUETOOTH CONNECTION

Refer to the setup and troubleshooting steps before contacting the store of purchase for assistance with connecting to Bluetooth.

If you have a complex AV setup, we recommend consulting your AV specialist for how this system fits in.

#### Q. I have everything connected but I can't hear any sound through my lounge?

A. Ensure the volume on your TV is turned up. Otherwise, double check you have followed the Setup steps correctly.

#### Q. I have sound coming from the lounge suite, but no sound coming from my TV?

A. This is the expected behaviour. Think of the lounge suite as a Bluetooth speaker - once connected, it becomes your TV's only audio output device.

#### Q. How do I adjust the volume across all of the seats - my volume dials aren't working?

A. The Primary seat controls the volume for all other seats. Check the seat has a **Blue** Bluetooth button lit, and use this seat to adjust the volume for the other seats.

#### Q. Can I adjust the other audio controls separately, or only on the Primary seat?

A. Yes - other than the Volume setting, the other settings (Treble, Bass and Vibration) are all controlled separately for each seat.

#### Q. What happens to the connection when I turn my TV off?

A. When you turn the TV back on the sofa will automatically reconnect and the seats will all stay connected together.

#### Q. What happens to the connection when I turn my sofa off?

A. When you turn the sofa back on, the Primary will reconnect to the last remembered device if it is available. The Secondary seats will need to be reconnected via the Bluetooth button on each seat.

#### Q. I'm having trouble getting connected, my Primary and Secondaries seem mixed up?

A. If you have any issues getting connected, the Primary seat may still be connected to a previous device (possibly a smartphone that was used to play music through the lounge). Ensure any other devices you don't want to use at this time are disconnected from the lounge suite or have their Bluetooth set to off, then power off the lounge suite for 2-3 minutes and begin setting up from Step 1.

#### Q. I have more than one Bluetooth button lit up Blue?

A. If you have more than one Bluetooth button lit up Blue (more than one Primary seat) - your seats may be connected to different Bluetooth audio sources. Ensure any previously connected devices are not still connected to any of the seats.

#### Q. The seat I don't want is the Primary, how do I change this?

A. Power every seat off. Power on only the seat you want to be the Primary. Connect to this first using Step 1 and then connect up Secondary seats using Step 2 and 3.